

CENTER TOWNSHIP SECTION 17 R10- TWP 6 MORGAN COUNTY, OH

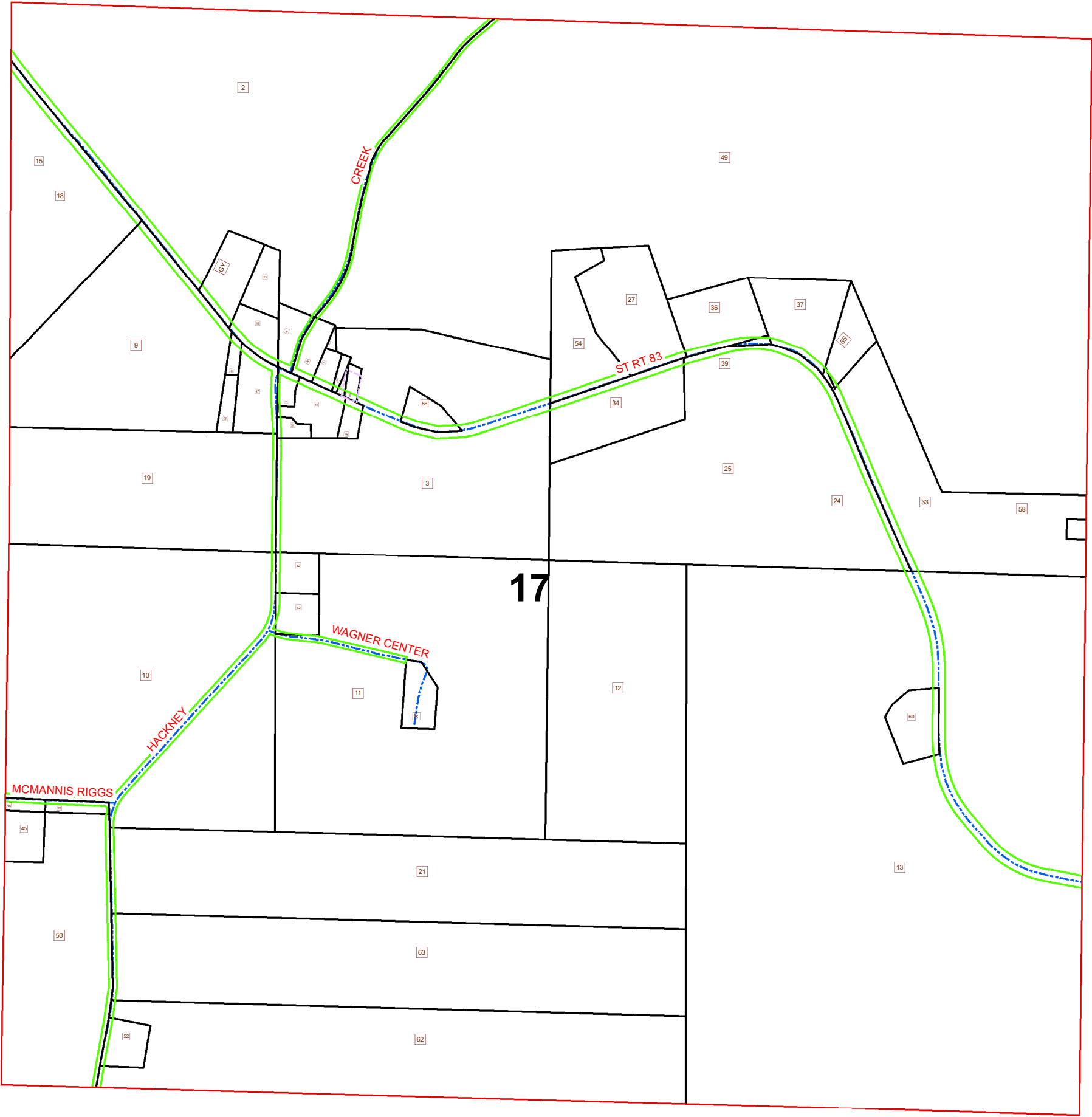

PIN	VOL	PAGE	Owner	LegalDescr	Acres
030-000-010-0	D.V 163	43	ABBOTT RICHARD EUGENE & BARBARA	R10 T06 S17 SD 16	0.98
030-000-020-0	D.V 163	43	ABBOTT RICHARD EUGENE & BARBARA	R10 T06 S17 SD 23	1
030-000-090-1	OR37	710	ALLEN JAMES MATTHEW & MANDY SUE	R10 T6 S17 SD 59	1
030-003-070-0	OR118	615	BENNETT STEVEN R & MARTHA A	R10 T06 S17 SD 15	12.46
030-600-210-0	OR226	64	BRIGHTER TOMORROWS INC	R10 T06 S17 LOT 3	4.82
030-000-140-0	OR51	595	BROWNRIGG DELILAH	R10 T06 S17 SD 48	0.49
030-000-130-0	OR139	360	BROWNRIGG DELILAH	R10 T06 S17 SD 47	1.74
030-008-780-1	OR51	595	BROWNRIGG RALPH E & DELILAH M	R10 T06 S17 SD 61	0.26
030-600-040-0	D. B "S"	28	CEMETERY (CATHOLIC)	R10 T06 S17 LOT 8	2
030-008-420-0	OR39	786	CONNELL CHRIS A	R10 T06 S17 SD 54	3.9
030-005-720-0	OR221	2385	CORBETT R CAUDILL CHIPPING INC	R10 T06 S17 SD 49	126.83
030-008-150-0	OR234	262	DEW ERIC D & BARBARA A	R10 T06 S17 SD 37	3.38
030-000-090-0	OR214	1023	DUSKEY TERESA L	R10 T06 S17 SD 32	1
030-008-560-1	OR210	2856	FERGUSON DAVID G & J MICHELE	R10 T06 S17 SD 62	27.681
030-003-830-0	OR224	2755	GREATHOUSE DONALD ALAN	R10 T06 S17 SD 53	0.08
030-003-820-0	OR224	2755	GREATHOUSE DONALD ALAN	R10 T06 S17 SD 6	0.17
030-003-210-1	OR219	903	HARPER JOSEPH A	R10 T06 S17 SD 55	1.42
030-003-810-0	OR224	2755	HART ELTON D	R10 T06 S17 SD 26	0.172
030-003-840-0	OR133	641	HART ELTON D	R10 T06 S17 SD 5	0.36
030-003-850-0	OR133	641	HART ELTON D	R10 T06 S17 SD 41	0.08
030-003-250-0	OR230	3491	HART ELTON D	R10 T06 S17 SD 14	1.84
030-001-830-0	OR229	1546	HERSHBERGER WAYNE A ET 9 AL	R10 T06 S17 SD 2	46.83
030-003-190-0	OR34	530	HOLLINS RODNEY E & CHRISTINA K CUR	R10 T06 S17 SD 4	0.79
030-008-560-0	OR210	2862	HUCK KATHY L & J EDWARD JR	R10 T06 S17 SD 21	27.684
030-008-560-2	OR210	2859	HUCK KIMBERLY S & RODNEY W	R10 T06 S17 SD 63	27.684
030-008-080-0	OR205	339	JETT KEVIN & L DIANE	R10 T06 S17 SD 35	0.33
030-003-520-0	OR207	432	KERNEN CLIFTON A & WANITA TOD-CLIN	R10 T06 S17 SD 28	0.28
030-003-510-0	OR207	432	KERNEN CLIFTON A & WANITA TOD-CLIN	R10 T06 S17 SD 50	13.3
030-007-320-0	OR216	2234	RIBBLE RODNEY R,BRENDA S EVANS, E	R10 T06 S17 SD 36	2.82
030-006-600-0	OR209	2885	RILEY MARIANNA L	R10 T06 S17 SD 52	1.08
030-007-640-0	OR143	545	SCHAADS DAIRY FARM PROPERTIES C/	R10 T06 S17 SD 12	20
030-007-650-0	OR143	545	SCHAADS DAIRY FARM PROPERTIES C/	R10 T06 S17 SD 11	36.771
030-007-670-0	OR150	5	SCHAADS DAIRY FARM PROPERTIES C/	R10 T06 S17 SD 19	18.5
030-007-680-0	OR150	5	SCHAADS DAIRY FARM PROPERTIES C/	R10 T06 S17 SD 3	28.001
030-007-660-0	OR143	545	SCHAADS DAIRY FARM PROPERTIES C/	R10 T06 S17 SD 10	39.25
030-007-930-0	OR89	575	STEGNER HARRY MAX	R10 T06 S17 SD 45	1.17
030-007-920-0	OR89	575	STEGNER HARRY MAX	R10 T06 S17 SD 46	0.33
030-008-780-0	OR174	702	STEWART TODD M & REBECCA D	R10 T06 S17 SD 09	16.75
030-008-410-0			STINE WILLIAM R & SHIRLEY	R10 T06 S17 SD 7-	0.32
030-008-400-0	D.V 203	38	STINE WILLIAM R & SHIRLEY	R10 T06 S17 SD 31	0.33
030-003-200-2	OR4	40	TRI-COUNTY RURAL WATER & SEWER D	R12 T06 S17 SD 58	0.23
030-007-690-0	OR204	3040	VELEY ROGER	R10 T06 S17 SD 40	0.81

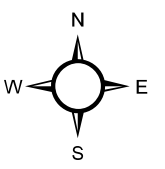

 Sections	— Hydro	 Parcels
Boundaries	— Lot	— Roads
Type	— Parcel	
— Hidden	— ROW	

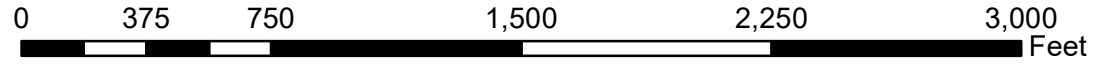

Source: Morgan County Engineer's Office
 Author: Marcia Wolfe
 Date: 3/18/2020

Disclaimer: The information that these maps contains is or reference purposes only. Please bring any erros to the attention of the Engineer's Office staff.
 Thank you

CENTER TOWNSHIP SECTION 17 R10- TWP 6 MORGAN COUNTY, OH

PIN	VOL	PAGE	Owner	LegalDescr	Acres
030-008-540-0	OR164	771	WAGNER DREW A	R10 T06 S17 SD 13	118.25
030-008-550-0	OR164	771	WAGNER DREW A	R10 T06 S17 SD 24	30.4
030-003-200-0	OR219	1057	WAGNER DREW A & SALLY M	R10 T06 S17 SD 33	12.941
030-008-540-1	OR223	1894	WAGNER DREW ALAN	R10 T06 S17 SD 60	1.747
030-007-680-1	OR216	1746	WAGNER PAUL L & LINDA R TRUST	R10 T06 S17 SD 56	0.844
030-007-650-1	OR216	1744	WAGNER PAUL L & LINDA R TRUSTEES	R10 T06 S17 SD 57	1.129
030-007-600-0	OR209	2424	WILSON SHARMA	R10 T06 S17 SD 27	4.96

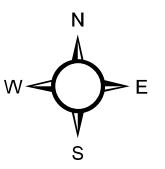
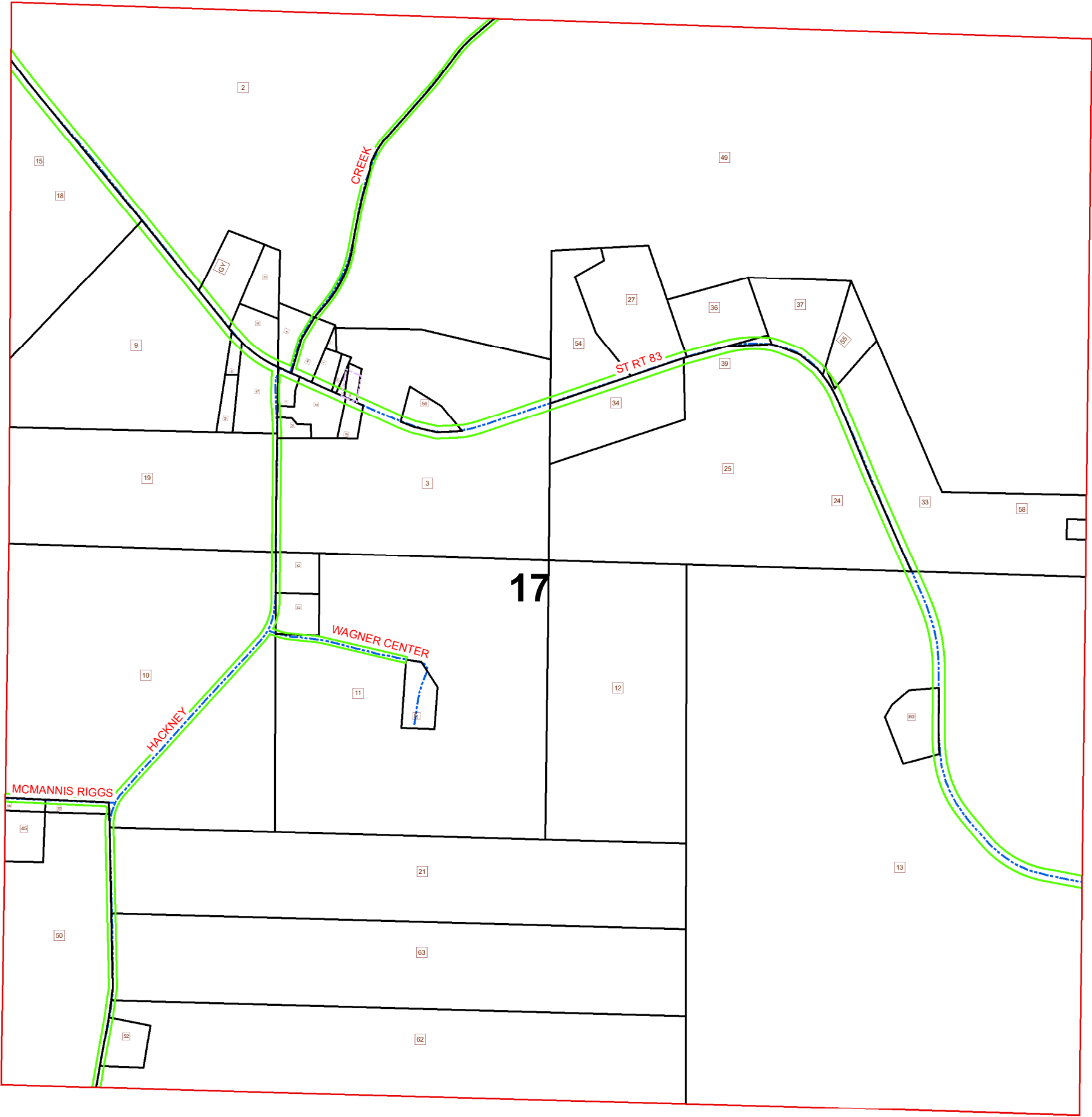

Boundaries		Type	
	Sections		Hydro
	Parcel		Lot
	Roads		ROW
	Hidden		

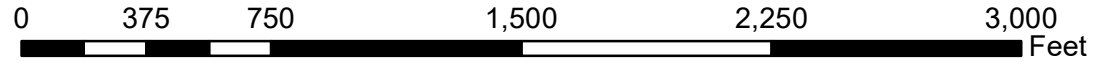

Source: Morgan County Engineer's Office
 Author: Marcia Wolfe
 Date: 3/18/2020

Disclaimer: The information that these maps contains is or reference purposes only. Please bring any erros to the attention of the Engineer's Office staff.
 Thank you